

# The Call Button TCL13

## INSTRUCTION MANUAL

Specially designed for deaf and hearing impaired people.





All your products are already connected to each other.

# Summary :

**4 - 6** : The Call Button TLC13

# The Call Button

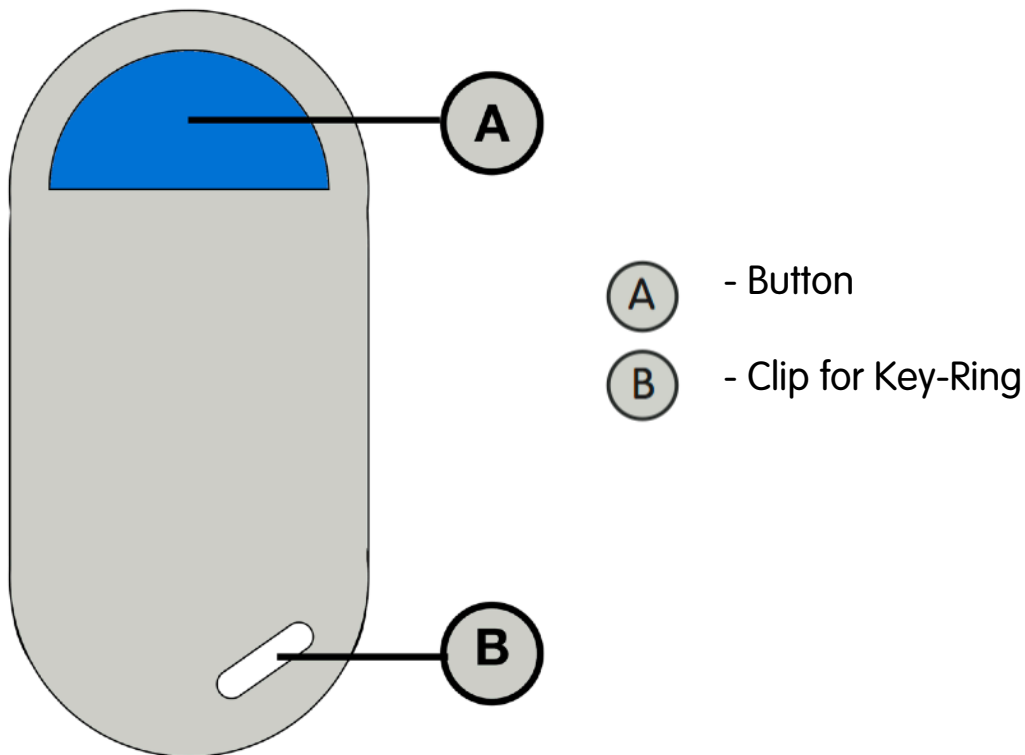

## Technical Specifications

**Weight** : 132 g

**Color** : Black

**Dimension (H x W X D )** : 55 x 30 mm

Transmitters with a reach of up to 150 meters in the open

**Radio Frequency** : 433,33 kHz

**Reception range of the radio waves** : 50 meters in free fields

**Power supply** : 12V battery included

**Autonomy** : 2 years (according to its current use )

2-year warranty

## Function :

The call button is specially designed to send a signal to the flash receivers and to the Jenile vibrators in order to call the deaf or hearing-impaired person located in another room.

A signaling system consists of at least one transmitter and one receiver.

When a person presses the call button, the signal is converted into radio pulses. These radio pulses (433 MHz) are transmitted wirelessly to Jenile flash or vibrating receivers.

Jenile's flashing or vibrating systems then light up / vibrate in green.

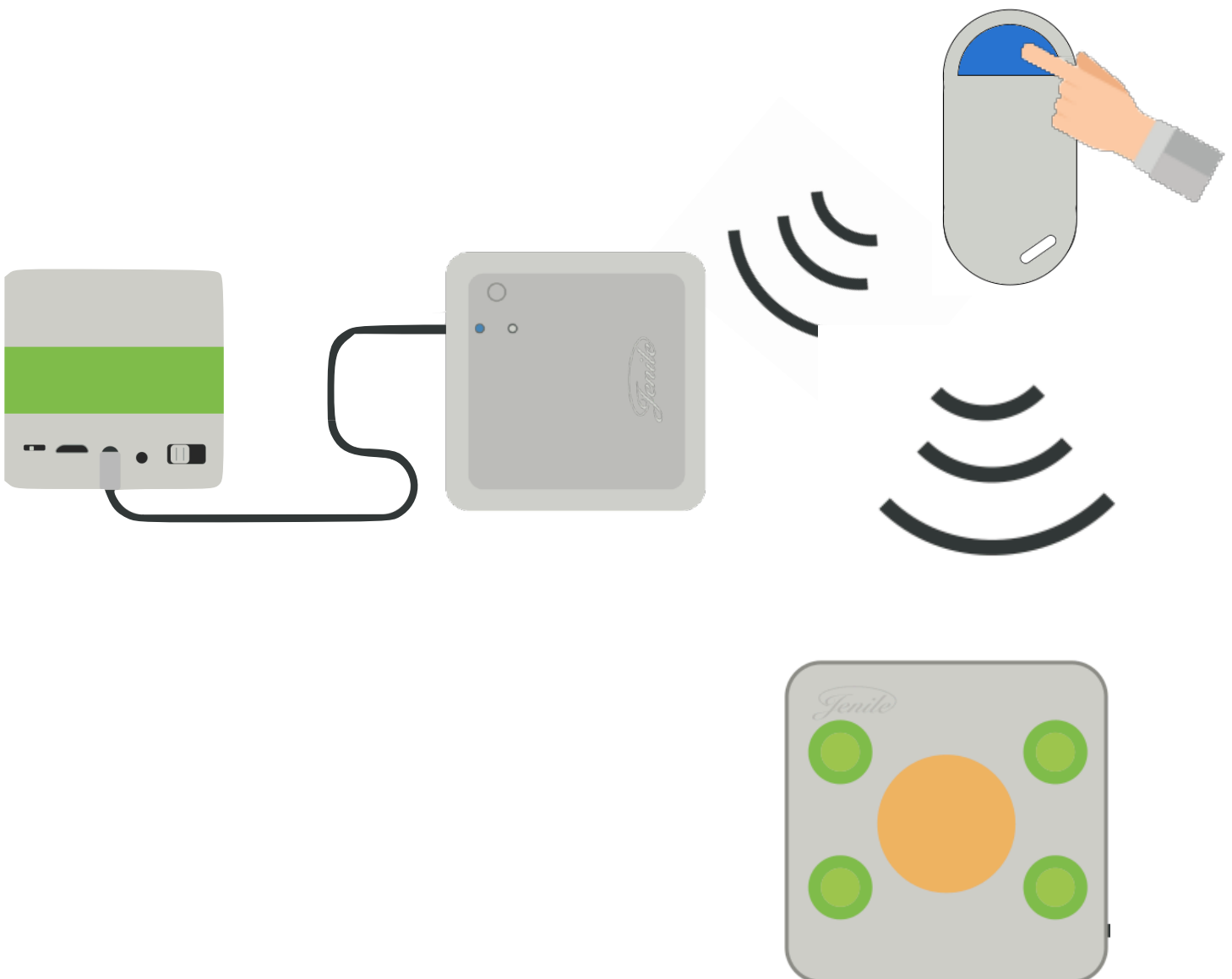

# Settings

The connection between the products is already done if you have received your same time as your pager button. Otherwise, the connection is very simple:

- 1- Press the plug button of the cube and release the button as soon as the receiver lights up in reds.

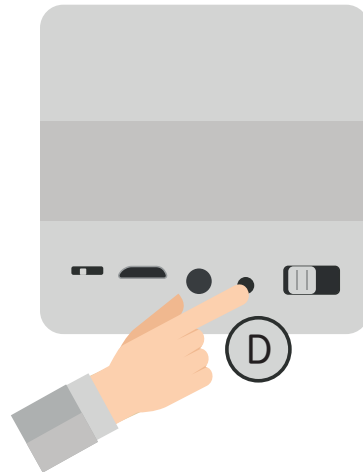

**WARNING** : do not hold down the button after the color lights up, you are at risk of deleting all previous connections)

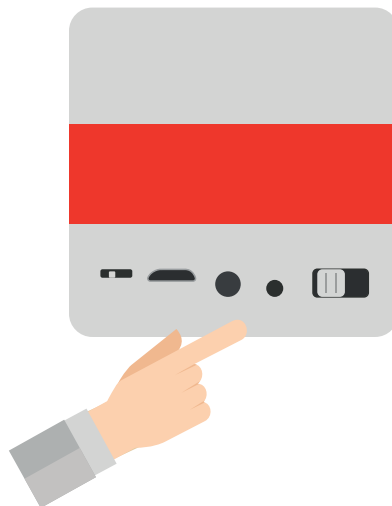

- 2- Press immediately on the call button while the red light is on.

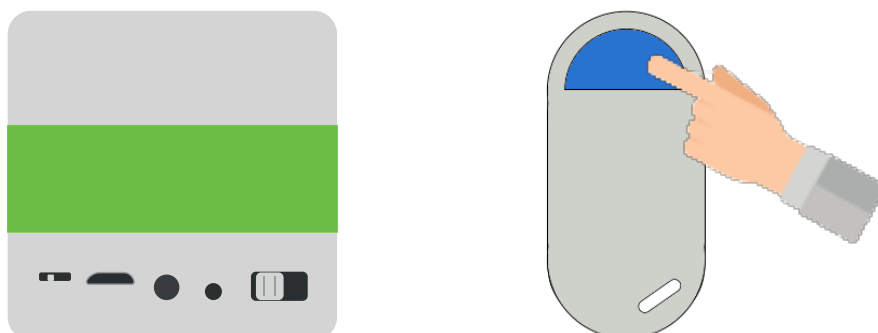





[www.jenile.com](http://www.jenile.com)

